



TUB WALL-MOUNT FAUCET SET

INSTALLATION INSTRUCTIONS

Before installing, read entire installation instructions. Observe all local building and safety codes.

Unpack and inspect the product for any shipping damages. If you find damages, do not install. Contact Customer Service at 1-866-855-2284. If you need assistance or have questions while installing your faucet set, contact Customer Service.

We recommend consulting a professional if you are unfamiliar with installing bathroom fixtures and plumbing. Signature Hardware accepts no liability for any damages to the floor, walls, plumbing or for personal injury during installation.

TOOLS AND MATERIALS:

Adjustable Wrench
Damp Cloth
Pipe Wrench

Basin Wrench
Pliers
Hacksaw

Plumber's Tape or Thread Sealant
Screwdrivers (Phillips and Flat Head)

WATER SUPPLY INSTALLATION

1. Slide the slip nuts (**B**) up the supply tubes (**C**). Place the rubber cone washers (**A**) on the top of the supply tubes.
2. Place thread sealant or plumber's tape on the copper or threaded pipes at the finished floor. Thread the pipe nipples (**H**) onto the copper or threaded pipes. Slide the bell flanges (**I**) over the pipe nipples and press the into place.
3. Apply thread sealant to the pipe nipples and attach the straight stop valves (**G**). Wipe away any excess sealant with a damp cloth. Allow sealant to cure for 24 hours before use.
4. Slide the compression nuts (**D**) onto the supply tubes (**C**). Slide the friction washers (**E**) and rubber cone washers (**C**) onto the supply tubes.
5. Place the supply tubes into the straight stop valves and tighten the compression nuts.
6. Close the straight stop valves and briefly turn on the main water supply to check for leaks. If leakage occurs, tighten the connections with an adjustable wrench as necessary. If problems persist, contact Customer Service.
7. Install the tub faucet according to the **Faucet Installation** section.

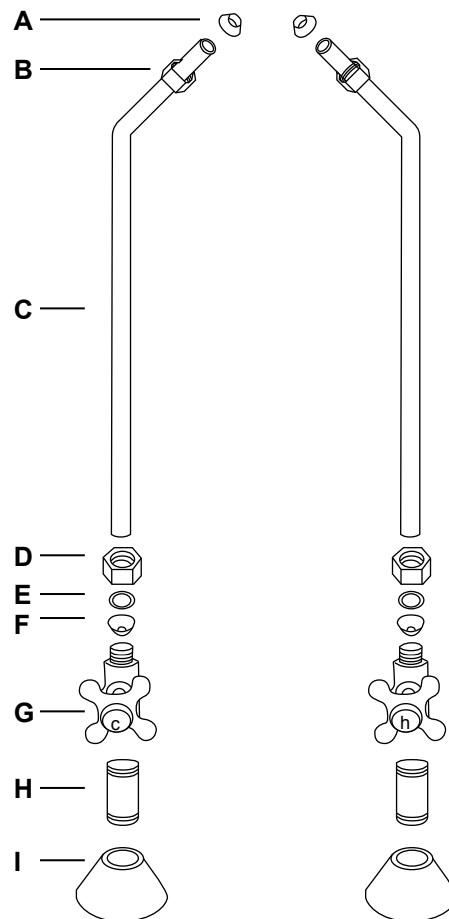

PARTS LIST

- | | |
|---------------------------|---|
| A. (2) Rubber Cone Washer | F. (2) Rubber Cone Washer |
| B. (2) Slip Nut | G. (2) Straight Stop Valve - 1/2" IPS x 1/2" OD |
| C. (2) Supply Tube | H. (2) 1/2" NPT Nipple |
| D. (2) Compression Nut | I. (2) Bell Flange |
| E. (2) Friction Washer | |



FAUCET INSTALLATION

1. Remove the lock nuts from the bottom of the faucet and insert the faucet through the mounting holes.
2. Hand-tighten washers (if included) and hex nuts to secure.
3. Check to make sure the faucet is properly aligned and adjust as needed. When the faucet is in the proper position, finish tightening the hex nuts with your adjustable wrench.
4. Attach the hot and cold water supplies to the water inlets on the bottom of the faucet. (Hot water is always on the left and cold water is always on the right)

Tip: Place plumber's tape on supplies and pipes before you attach supply lines to ensure leak free connections.

5. Finish your installation by attaching any hoses and/or handles that might be included.
6. After all connections have been made, turn on the water supply, check to make sure that all connections are tight (no water should be leaking) and that the hot and cold supplies are working correctly. Turn the faucet on and allow the water to flow through the spout for approximately 60 seconds. If you have a hand shower, divert the water to the hose and allow the water to flow through the hose for an additional 60 seconds.

INSTALLATION

Note: Because tubs vary in size, measure your space thoroughly before installation. Trim pipes accordingly to ensure a correct fit. Go to the **Trimming Drain Pipes** section for more information.

1. Apply thread sealant or plumber's tape to the threads at each end of all pipes prior to installation. If two pipes arrive attached, be sure to take them apart and apply sealant before installing.
2. Connect the tub shoe assembly (A), and rubber washer to the tub drain (B).
3. Install the overflow assembly (C) with the beveled washer, overflow plate, mounting screw (provided) and any other washers or rubber sealing gaskets included.
4. Attach the waste and overflow tee (D) to the overflow assembly (C) and shoe assembly (A) with sealing washers and slip nuts.
5. Attach the drain tube and flange (E) to the waste and overflow tee (D) with the sealing washer and slip nut.

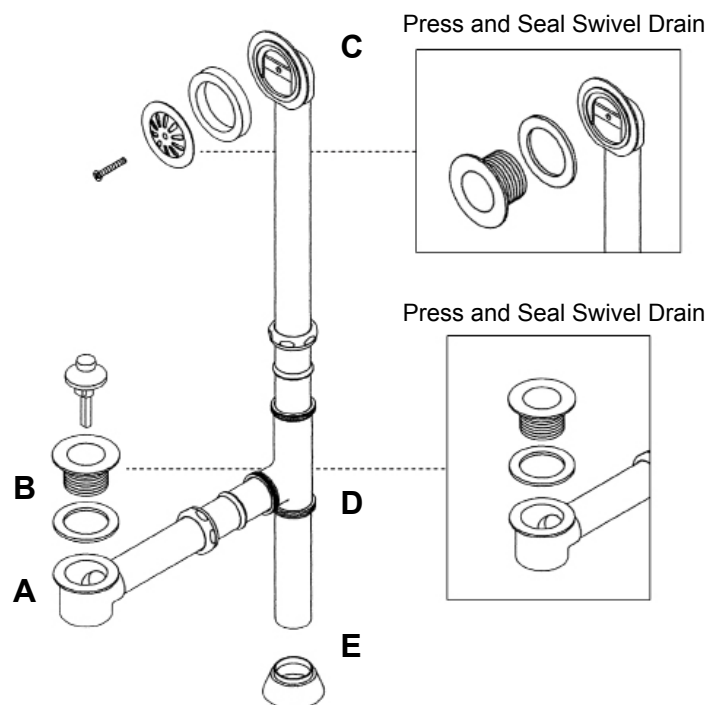



TRIMMING DRAIN PIPES

1. Connect the overflow and drain assemblies and pipes to the tub.
2. The T-connection will be attached at the points where the drain pipes intersect. Measure and mark each pipe so that the ends reach a little over halfway into the T-Connection hubs.
3. Trim the pipes as necessary with a hack saw with a blade that is suitable for cutting metal.

